

FAMIS Cloud: Viewer Guide

Viewing Spaces and Maps

Introduction to FAMIS Cloud

FAMIS Cloud is the next step forward for FAMIS, the Accruent software UNM uses each day for viewing and updating campus space data and visual maps.

Up until 2020, our instance of FAMIS had been installed on UNM servers. This local version of FAMIS was called FAMIS Classic. With FAMIS Cloud, the Space team has migrated FAMIS to a visually and functionally updated version of the software hosted on Accruent's servers.

FAMIS Cloud for Viewers

As a FAMIS Cloud **Viewer**, your permissions will allow you to:

- ✓ **Find and view a location** – includes [Properties](#) and [Spaces](#)
- ✓ **View a Property's Visual Map** – includes applying labels and themes to adjust the image to your need

This guide will walk you through the above functions in FAMIS Cloud and get you familiar with the Cloud user interface, which is the greatest change from FAMIS Classic.

Please send your questions and feedback to space@unm.edu to reach the Space team.

Finding a Location

Space data has been migrated to FAMIS Cloud. We will start by learning to search this data, which is organized by Properties and Spaces. A Property is a building, which we will look up first and continue from there to more granular locations.

Logging In

Logging in is similar to the way you log in to many UNM applications.

FAMIS Cloud performs best in Internet Explorer. In the browser, navigate to famis.unm.edu, and you will be routed through the LoboMail sign-in process. Enter your UNM email and password into the prompts:

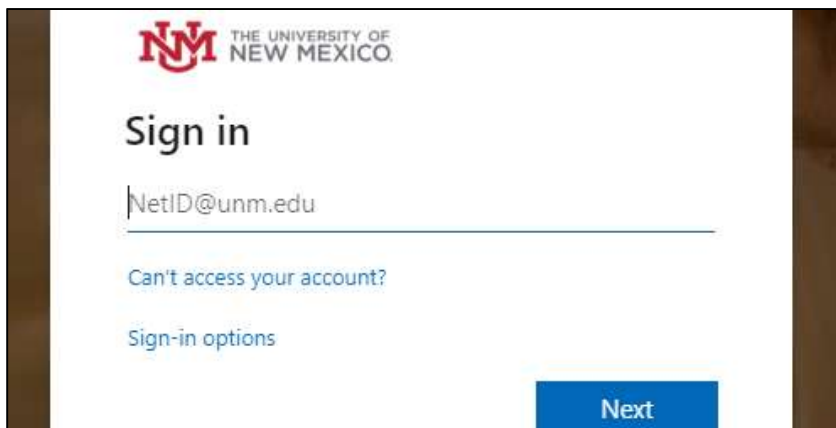

A successful sign-in will bring you to the Find Space page in FAMIS Cloud:

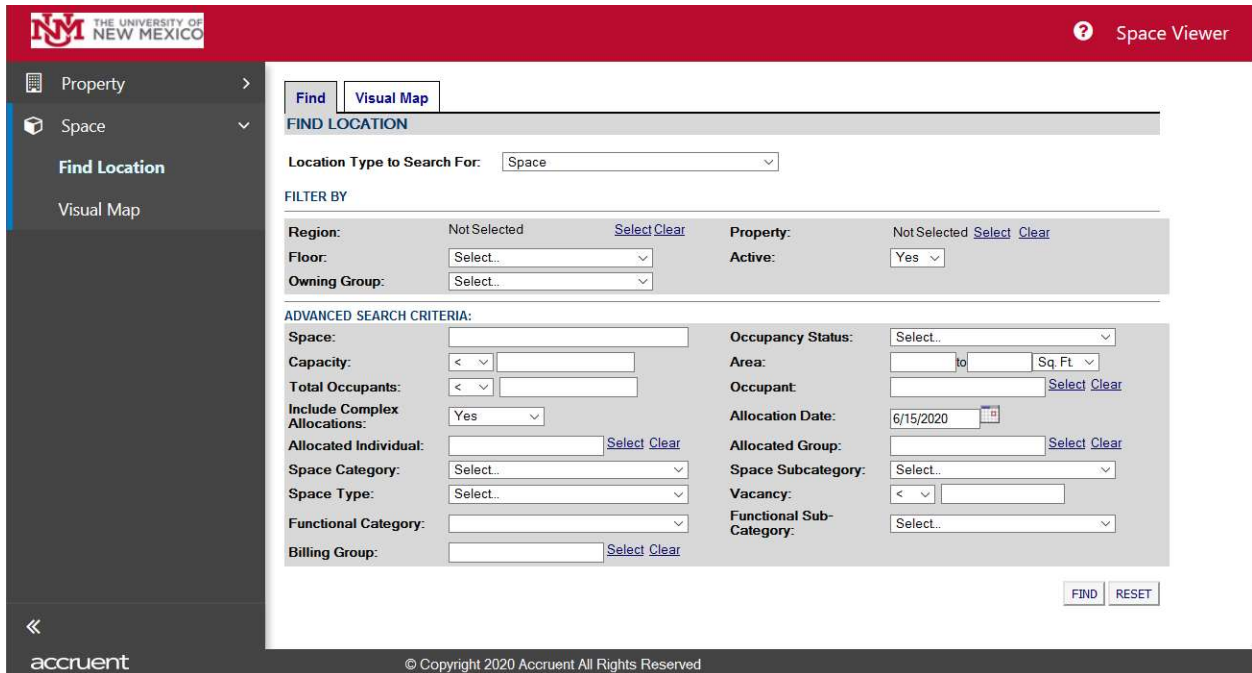

Search For A Property

We will start by opening the “Property” menu on the left side of the screen. Click on “Property” to open the menu, and then select “Find Property”:

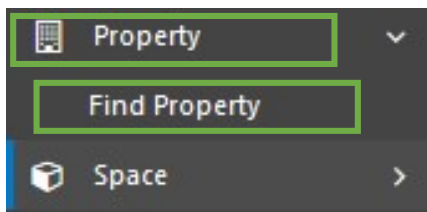

You will now see a number of search fields on the main display:



Search for a building of your choice using any one or combination of fields that represent what you know about that building. Some are manual entry, and others are dropdowns. **For the meanings and FAMIS Classic equivalents of all FAMIS Cloud search terms, see the Search Term Glossary at the back of this guide.**

Click “Find” when you have entered your search terms, and you will instantly see any results:

Property:	<input type="text" value="Casterter"/>	Region:	<input type="text" value="Albuquerque"/>
City:	<input type="text"/>	State/Province:	<input type="text" value="Select..."/>
Zip:	<input type="text"/>	Country:	<input type="text" value="Select..."/>
Property Type:	<input type="text" value=""/>	Square Footage:	<input type="text"/> to <input type="text"/>
External Property ID 1:	<input type="text"/>	External Property ID 2:	<input type="text"/>
		Status:	<input type="text" value="Active"/>

SEARCH RESULTS (1) [EXCEL](#) | ITEMS TO 1 (OF 1)

Property Name	Type	City	State	Zip	Country	Sq Ft
A0021 - Casterter Hall	Building	Albuquerque	New Mexico	87131	United States	153384

Viewing Property Details

Click on your desired Property’s name in its search result, which is a link. This will take you to its detail page:

Find Property

GENERAL INFORMATION

SELECT PROPERTY

Building #**:	A0021	Building Description:	CAST
Property Name:	A0021 - Casterter Hall	Property Type:	Academic
Address 1:	219 Yale Blvd. N.E.		
Address 2:			
City:	Albuquerque	State:	NM
Zip:	87131	Country:	US
Sq Ft:	153384	Property Currency:	\$ US Dollar (USD)
Property Tier:		Property Disposition:	
Operational Status:		Status:	Active

▶ [FACILITY MANAGEMENT](#)

▶ [PROPERTY SPACE](#)

In addition to the data you see in the building’s General Information, there are a number of dropdown tabs below with even more, categorized building information. For example, under “BR&R and O&M” is where to look for BR&R eligibility and square footage, and “Building Details” contains additional structure details such as year built and Net Asset Category:

▼ BUILDING DETAILS			
Bldg Efficiency Ratio:	62%	Campus Group:	MAIN CAMPUS
Campus Location:	CENTRAL	Net Asset Category:	Repair & Maintain
Net Asset Value (NAV):	87%	Status:	OPEN
UNM Map Grid:	K-17	Year Built:	1951
▶ HISTORIC PRESERVATION			
▶ UNM FACILITIES MANAGEMENT & CLERY			
▼ BR&R AND O&M			
BRR Eligibility:	100%	BRR Location:	A - Main Campus
BRR SF:	153384	OM Eligibility:	100%
OM SF:	153384		
▶ BUILDING CONTACTS			

Browse these tabs according to your interest in the building, and let the Space team know if there is any missing information that you would like to see.

One of these tabs is “Property Space”, which contains a list of Spaces in the building and links to their Space profiles:

▶ FACILITY MANAGEMENT				
▼ PROPERTY SPACE				
Status	Description	Account	Contact	Room Type
InActive	2E1			
InActive	2E2			
InActive	2E3			
InActive	2E4			
Active	2E1			
Active	2E2			
Active	2E3			
Active	2E4			
Active	1			
Active	1 E1			

Searching For a Space

If you are looking up a Space, going through the building is one way to find its profile, as shown above.

However, in this guide, we will get to the same details using the Find Location search page. Return to the left side bar, and open up the Space menu item. In here, click on “Find Location”.

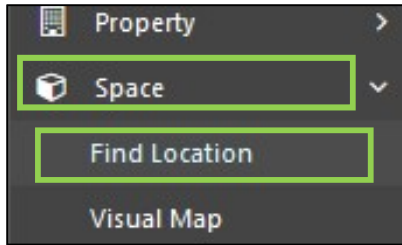

The first step you will see to finding a location is a dropdown to select the type of location you would like to find. You will notice that the menu includes the option to search for a Property. This option is another way to get to the same Find Property window you used earlier.

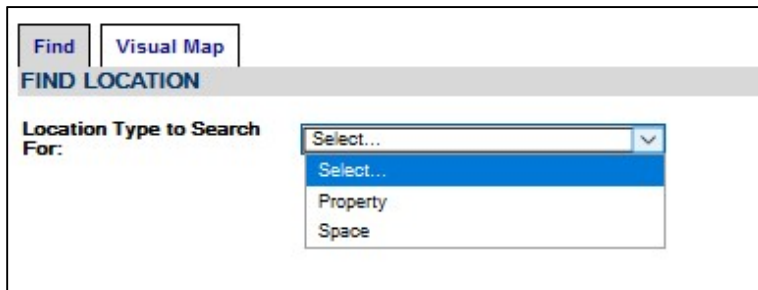

Instead, select "Space". The fields to enter Space search criteria will appear:

Before entering your search terms, make sure that "Include Complex Allocations" is set to "Yes". Because Space occupation is very intricate in a university context, the Space team has chosen to use FAMIS's Complex Allocation interface to assign categories, individuals, and groups to Spaces. Complex Allocations allow allocating multiple groups to a Space at varying percentages. As a result, much of a Space's data is stored in this system.

As with properties, use any field or combination of fields to search for a room or other Space that is familiar to you. See the end of this document, again, for a glossary of FAMIS's search terms.

It may be easiest to search for a Space by filtering for its Property and floor. Next to the Property field, click "Select":

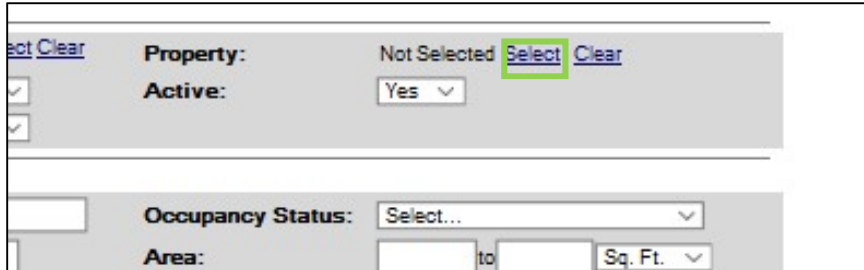

Property: Not Selected **Select** Clear
Active: Yes
Occupancy Status: Select...
Area: to Sq. Ft.

A selection dialog will appear, where you can search for a building by name, number, abbreviation, address, or region (campus):

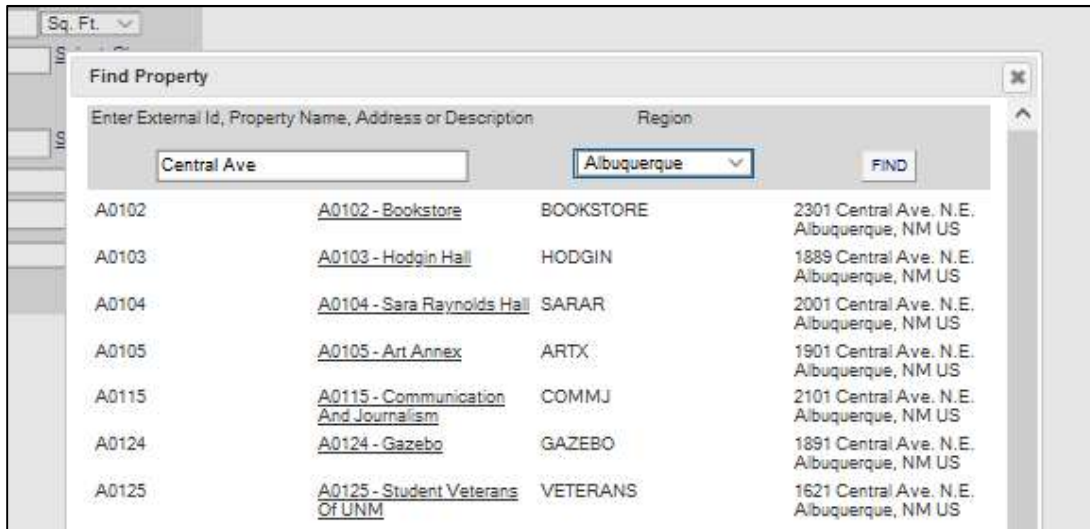

External Id	Property Name	Abbreviation	Address
A0102	A0102 - Bookstore	BOOKSTORE	2301 Central Ave. N.E. Albuquerque, NM US
A0103	A0103 - Hodgkin Hall	HODGIN	1889 Central Ave. N.E. Albuquerque, NM US
A0104	A0104 - Sara Reynolds Hall	SARAR	2001 Central Ave. N.E. Albuquerque, NM US
A0105	A0105 - Art Annex	ARTX	1901 Central Ave. N.E. Albuquerque, NM US
A0115	A0115 - Communication And Journalism	COMMJ	2101 Central Ave. N.E. Albuquerque, NM US
A0124	A0124 - Gazebo	GAZEBO	1891 Central Ave. N.E. Albuquerque, NM US
A0125	A0125 - Student Veterans Of UNM	VETERANS	1621 Central Ave. N.E. Albuquerque, NM US

Click a Property name to add it to your Space search terms.

To narrow down to the floor that contains your Space, select the correct floor descriptor from the dropdown to the left of Property:

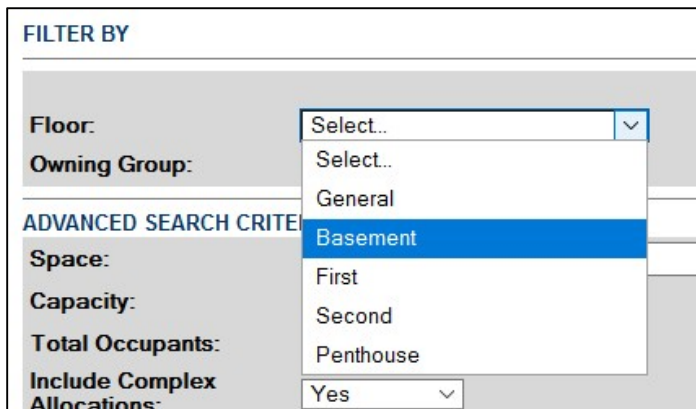

FILTER BY

Floor: Select...
Owning Group: Select...
General
Basement
First
Second
Penthouse

ADVANCED SEARCH CRITERIA

Space:
Capacity:
Total Occupants:
Include Complex Allocations: Yes

In the following example images, we will search without entering a specific Space, but for the narrowest possible search results, enter your Space's number in the Space Description field:

ADVANCED SEARCH CRITERIA:

Space Description: **Occupan**

Capacity: **Area:**

When finished, click "Find" for your search results:

FILTER BY

Floor: **Property:** A0021 - Castetter Hall [Select](#) [Clear](#)

Owning Group: **Active:**

ADVANCED SEARCH CRITERIA:

Space Description: **Occupancy Status:**

Capacity: **Area:** to Sq. Ft.

Total Occupants: **Occupant:** [Select](#) [Clear](#)

Include Complex Allocations: **Allocation Date:**

Allocated Individual: [Select](#) [Clear](#) **Allocated Group:** [Select](#) [Clear](#)

Space Category: **Space Subcategory:**

Space Type: **Vacancy:**

Functional Category: **Functional Sub-Category:**

Billing Group: [Select](#) [Clear](#)

FIND LOCATION RESULTS (159)

Property	Floor	Space
A0021 - Castetter Hall	Second	2E1
A0021 - Castetter Hall	Second	2E2
A0021 - Castetter Hall	Second	2E3
A0021 - Castetter Hall	Second	2E4
A0021 - Castetter Hall	Second	2-E2
A0021 - Castetter Hall	Second	2-S2
A0021 - Castetter Hall	Second	2-S6
A0021 - Castetter Hall	Second	202

Viewing a Space

Click a Space of interest in your search results to go to the Space's detail page. To open the space in a new tab, hold down the Ctrl key while clicking the link. This will keep your search results open in case you need to return to them.

A0021 - Castetter Hall	Second	203
A0021 - Castetter Hall	Second	203A
A0021 - Castetter Hall	Second	204
A0021 - Castetter Hall	Second	205

VIEW SPACE - GENERAL INFORMATION		Find Space
External Property ID: A0021	External Space ID: A0021_02_204	
Property: A0021 - Castetter Hall	Description: Research Lab - Wet	
Floor: Second	Last Updated: 1/9/2020 7:38 AM	
Active: Yes	Tab Order: 70	
Space: 204	Last Updated By: zAdmin2, 360	
Telephone:	Class:	
Survey Group:		
<hr/>		
▶ CATEGORIZATION		
<hr/>		
▶ OCCUPANCY		
<hr/>		
▶ ASSOCIATED SUB-SPACES		

The Space detail page will function similarly to Property detail pages, with general information that is immediately viewable, but specific categorized details also in dropdowns underneath the General Information section.

Here is additional data about the categorization and region associated with room 204 in Castetter Hall:

▼ CATEGORIZATION	
Allocations & Ownership	
Allocated Individual:	Complex
Allocated Group:	Complex
Owning Group:	
Billing Group:	
Ownership Status:	Own
<hr/>	
Functional Usage	
Functional Status:	OPEN
Space Functional Category:	Complex
Space Functional Sub-Category:	Complex
<hr/>	
Categorization	
Space Category:	200 - Laboratory Facilities
Space Sub-Category:	2500 - Research/Non-Class Laboratory
Space Type:	25001 - Research Lab - Wet
Space Standard:	
Space Standard Approval:	No
<hr/>	
Associated External Space Standards & Codes	
None found.	
<hr/>	
▶ OCCUPANCY	
<hr/>	
▶ ASSOCIATED SUB-SPACES	
<hr/>	
▶ AREA	
<hr/>	
▶ COMPLEX ALLOCATIONS	
<hr/>	
▶ CONTACTS	Add Contact Add Contact Company Add Contact Group
<hr/>	
▼ REGIONS	
Regions	Company Associated
Albuquerque	UNM
UNM - All	UNM

Viewing Visual Maps

The main profiles of Properties and Spaces are usually the quickest way to find facts and details on a location, but what if the information you need is better viewed on a floor plan?

As in FAMIS Classic, FAMIS Cloud still has the option to view Spaces in the Visual Map interface. As before, drawings of our floors and buildings are loaded into FAMIS from the AutoCAD files in UNM's virtual Plan Room.

Navigating to Visual Maps

There are two ways to reach the Visual Map interface for a Space. First, you may reach it from the Space profile by clicking the Visual Map tab overhead:

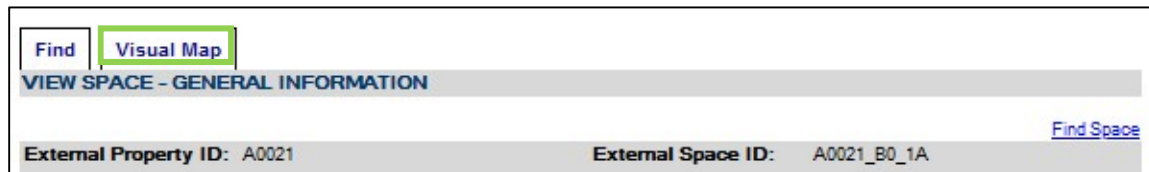

This tab does not appear over Property profiles. The other way to reach Visual Map is from the left sidebar, in the Space menu:

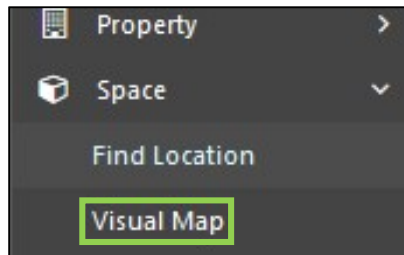

Either option will take you to the Visual Map interface. In this example, we are looking at the Visual Map of Castetter Hall:

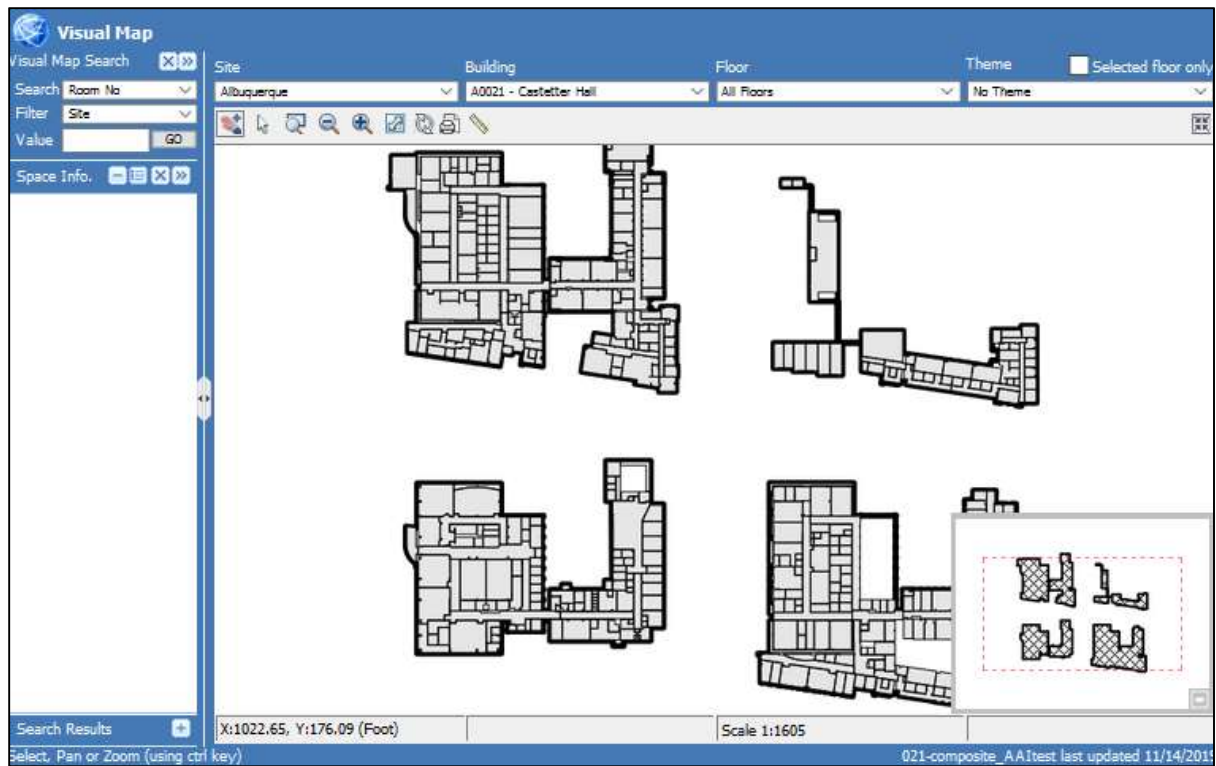

Visual Map Search

When using Visual Maps, there are two ways to search for the map or part of the map you want. First, you can find and select your site (example: Albuquerque), building, and floor (if you would like to zoom in on just one floor of the image) from the top bar of the interface:

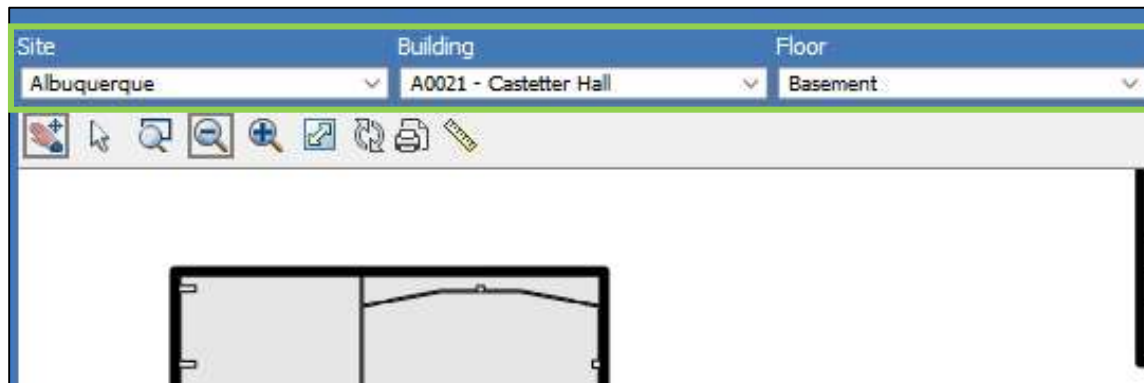

If you just want to look at the entire composite drawing, “All Floors” is an option.

For a more granular way to search, focused on a specific Space, use the “Visual Map Search” on the left sidebar:

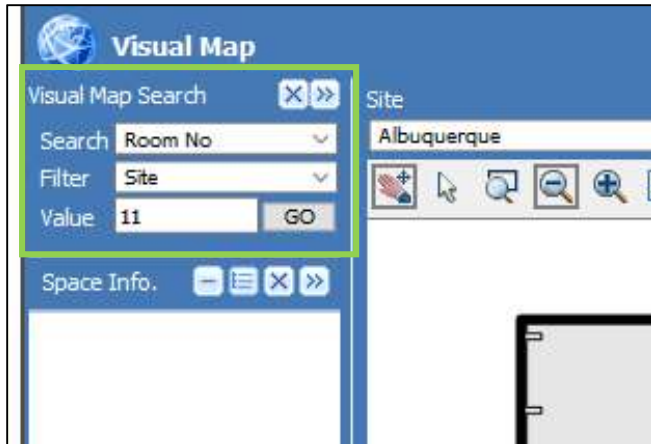

First, start by selecting the type of value you would like to search by. For example, if you would like to search for your desired Space by room number, select "Room No" in the "Search" field:

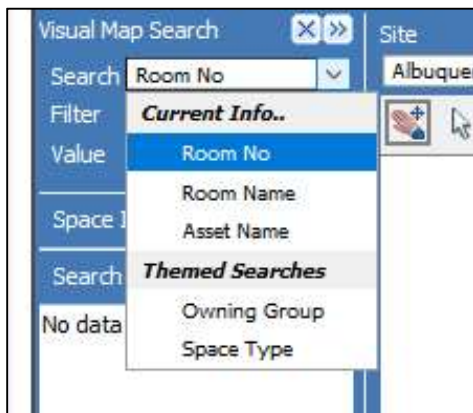

Next, select how you would like to filter your search results. While Visual Map Search can be used as a separate mode of search from the top bar dropdowns, items you select on the top bar can help filter your search here.

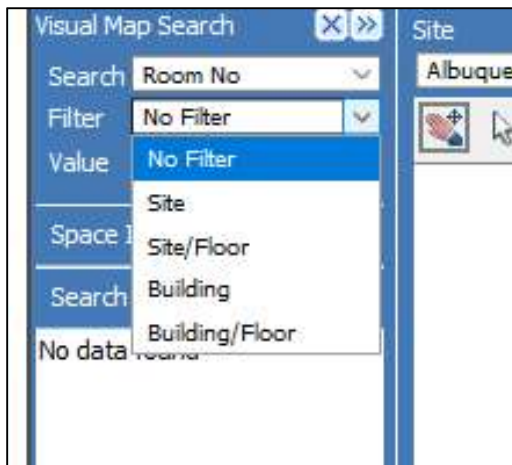

Selecting "No Filter" is the simplest option, but probably will result in many more search results to browse than you want.

To filter your results, you may use one or a combination of two fields that also appear in the top bar of the interface:

- Filtering by Site will show Space results only for the site you have selected in the top bar.
- Filtering by Site/Floor will show Space results only within your selected site *and* selected floor – such as all second floors in the Albuquerque site.
- Filtering by Building will give Space results only within the building you have selected in the top bar.
- Filtering by Building/Floor will give Space results only within the selected floor of your selected building.

Let's filter by Building/Floor in Castetter Hall, and search for a Space on the basement floor.

After choosing "Room No" as our search value, select Building/Floor for a filter:



Now, it's time to move back over to the top bar and select the following:

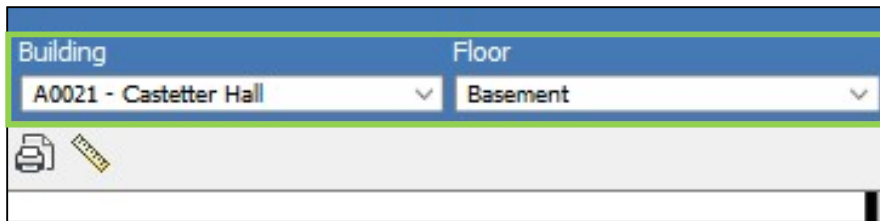

Your search results will now be constrained to Castetter Hall's basement level.

If you would prefer, you can now click "Go" in the Visual Map Search to display a list of all Castetter Basement rooms to browse:

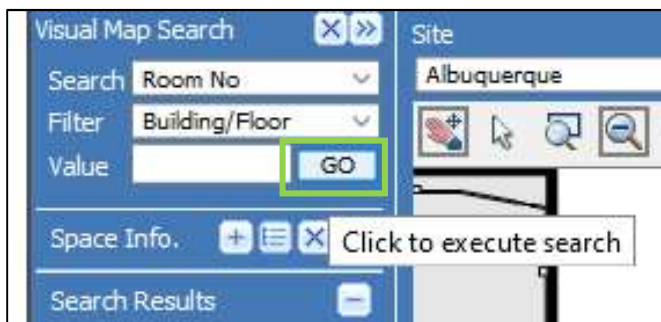

The result of this action will be ten pages of rooms. Click "Next" to browse to the next page of results, and click on any result to center and select it on the visual map:

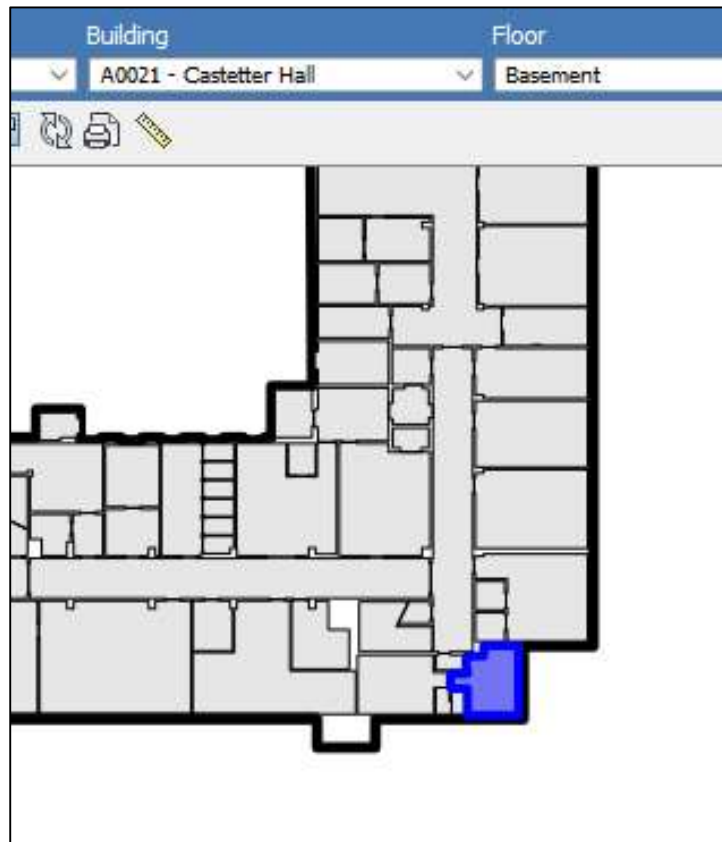
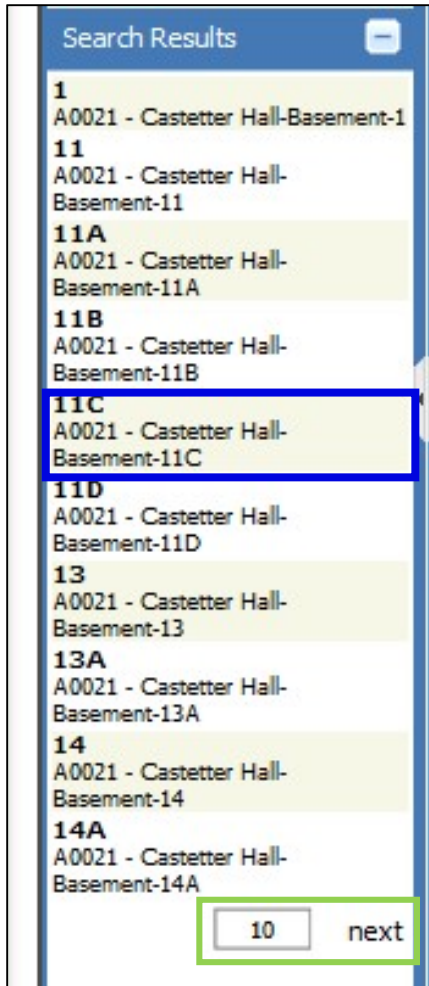

To avoid a manual search, enter a value in the “Value” search box, of the Space you would like selected on the visual map. Search for room 11C by entering this value in the Value field, and then click “Go”:

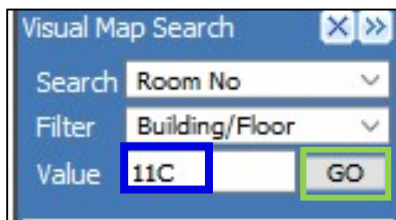

This will select the room immediately on the map:

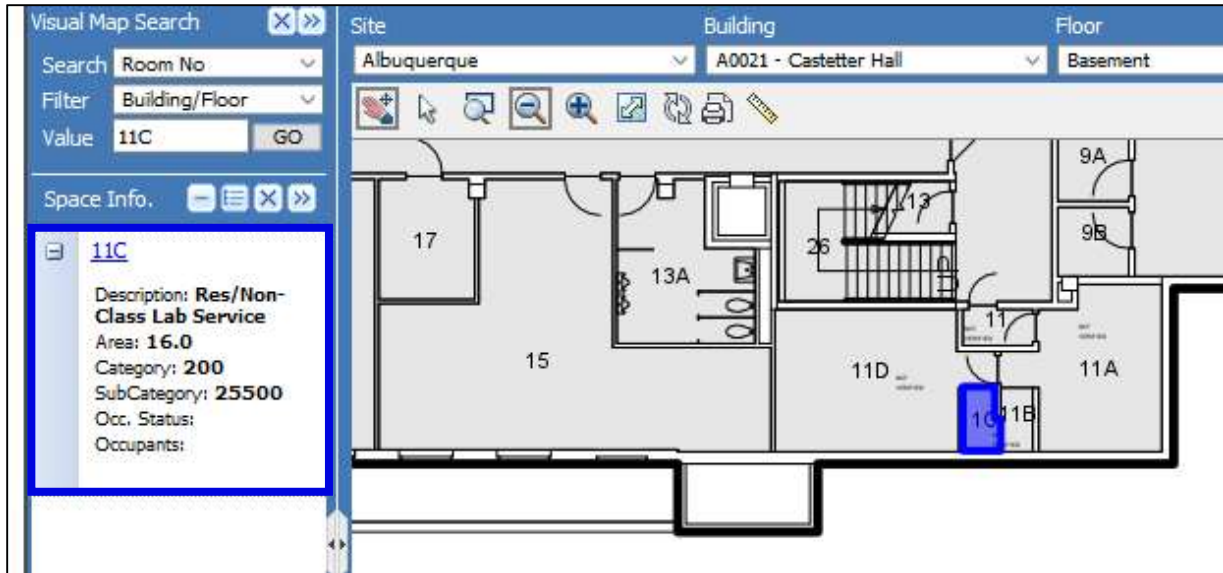

Key information about your selected Space will display on the left, such as Area (square footage), Category, and the link to its profile. This is under a section of the sidebar called “Space Info”. Your previous search results still exist, just closed at the bottom of the sidebar. You can click the closed “Search Results” section to re-open them:

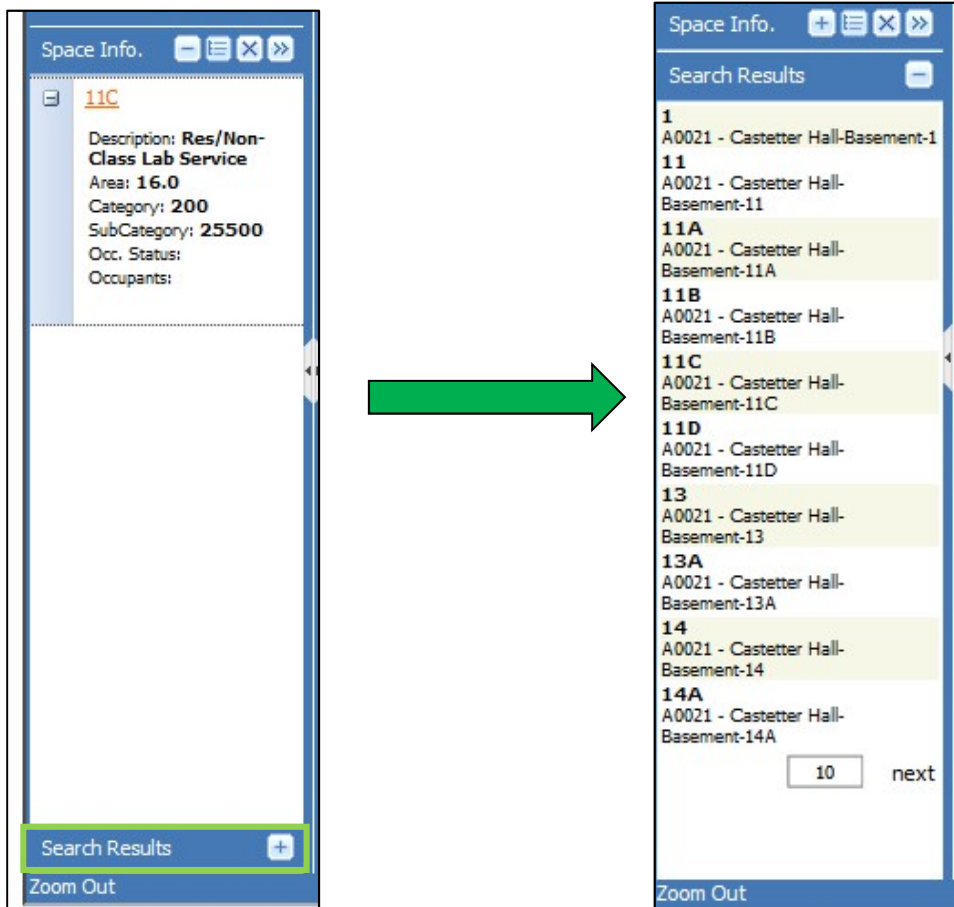

Click the name of the “Space Info” section to return to the information on your currently selected Space.

Map Image Manipulation

Another way to select a new Space and display its information in Visual Map is to just click it on the map image, but only if you are using the correct mouse tool. To find a Space on a map by moving and zooming around the map, and to manipulate the image in general, there are several tools you can use:

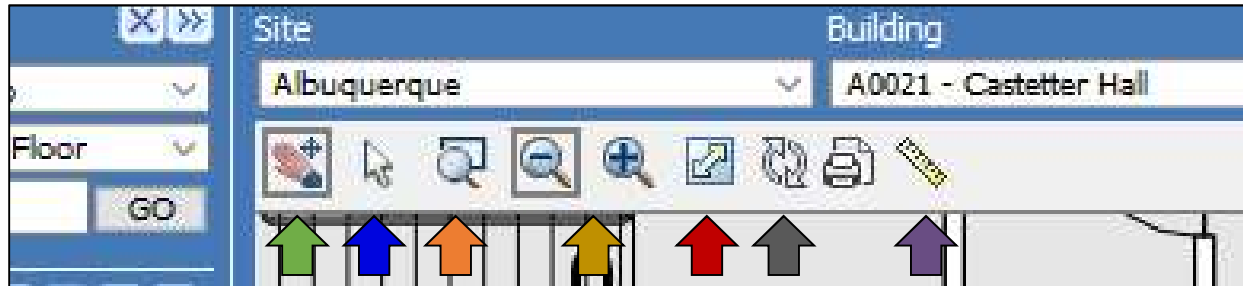

- **Navigation/Select:** When this tool is selected, click and drag to move the map image. Click a Space to select it.
- **Select:** When this tool is selected, click a Space to select it, or click and drag over multiple Spaces to select the multiples.
- **Zoom Window:** Click and drag to select a rectangular area, and release the mouse button to zoom in to that area.

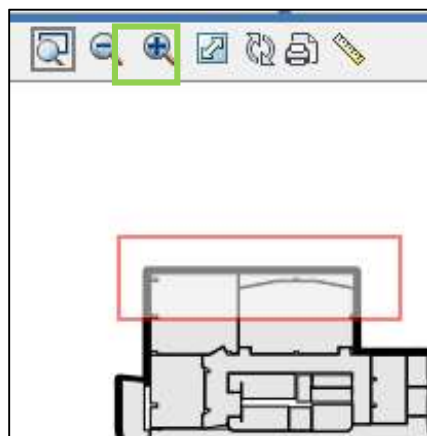

- **Zoom In/Out:** Click these buttons to instantly zoom in or out. Your mouse's scroll wheel can also be used to zoom, with an even greater degree of control.
- **Zoom To Extents:** This will zoom out to a distance where you will be able to see the entire composite map image (all floors) on one screen:

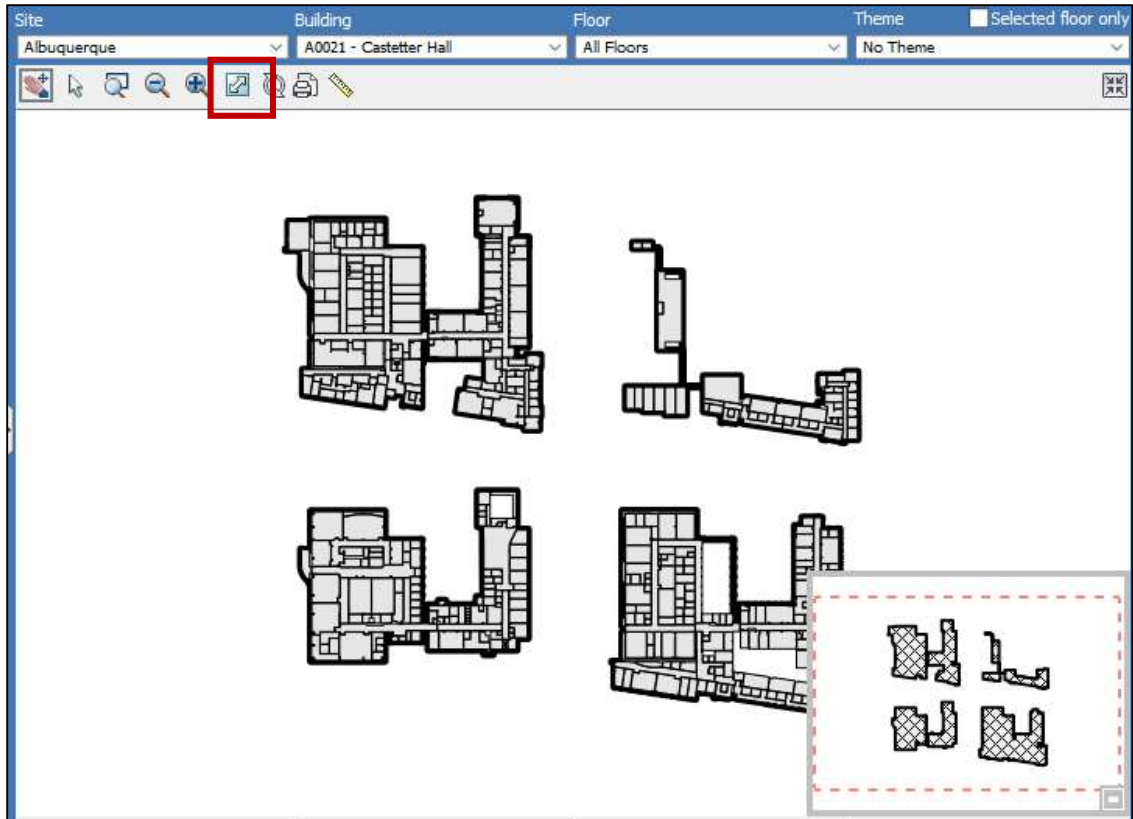

- **Reload:** Will refresh and re-draw the visual map from the AutoCAD file.
- **Measure:** your cursor will become an orange dot. Click on the map to add points to a line whose distance will be totaled in the "Distance" display below the map. Click the ruler icon again to delete your line.

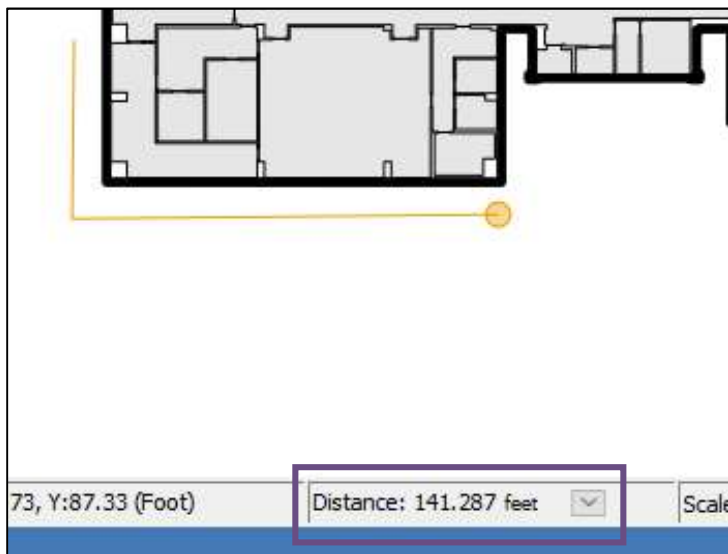

You may already have noticed one more way to move around the Visual Map image, the Overview Map:

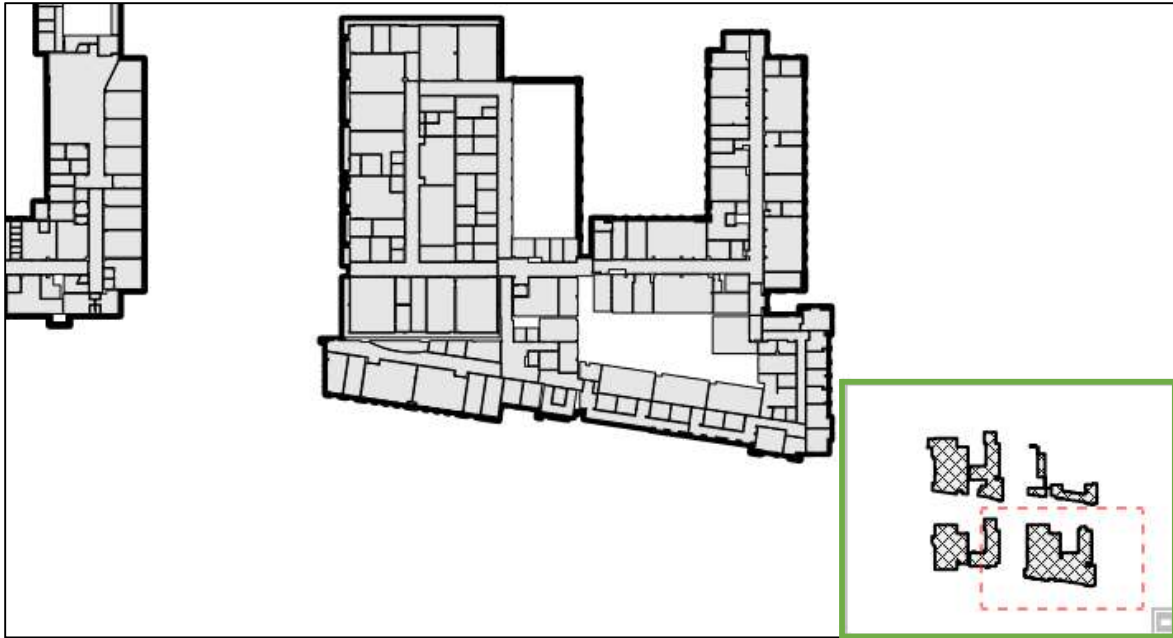

This is the small image of the full map in the lower right corner of the display. The red dashed box in the Overview Map represents your zoom window. Zooming out increases the size of the zoom window. Zooming in will make it smaller. What you can do specifically in the Overview Window is click and drag your zoom window to different parts of the map:

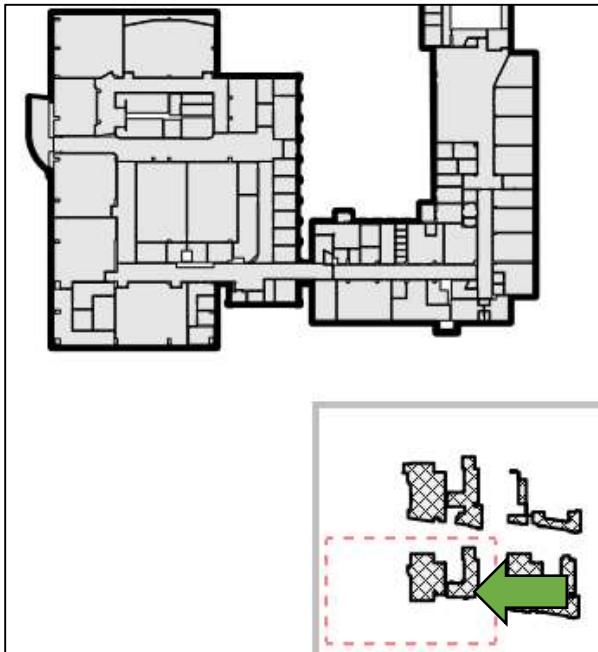

Printing a Floorplan

There is one final button on the toolbar, Print:

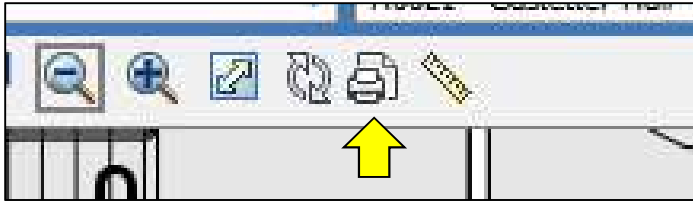

Clicking this button will bring up the Print dialog:

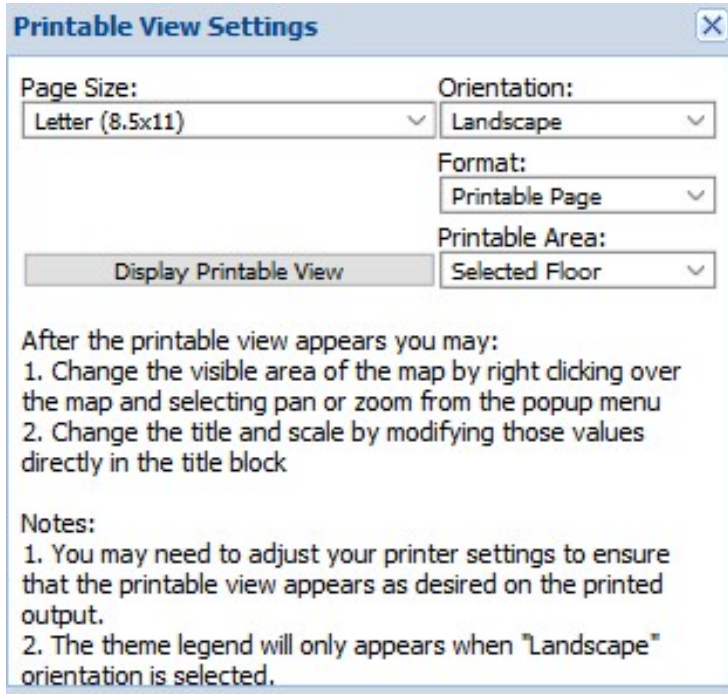

First, choose your page size. Customizing your page size is an option if your desired size is not on the dropdown list.

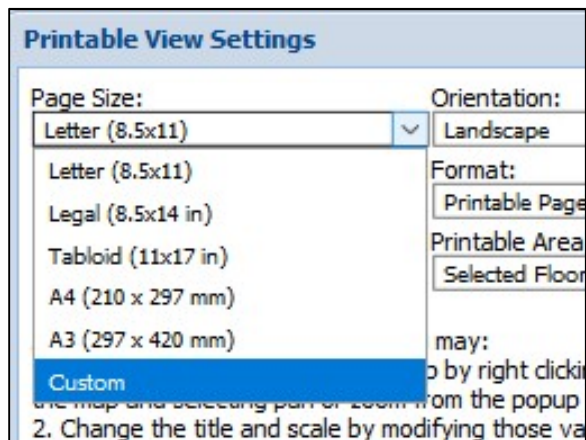

Choose Portrait or Landscape for your paper orientation, and then from the format options. Most likely, you will want a Printable Page or Image Only:

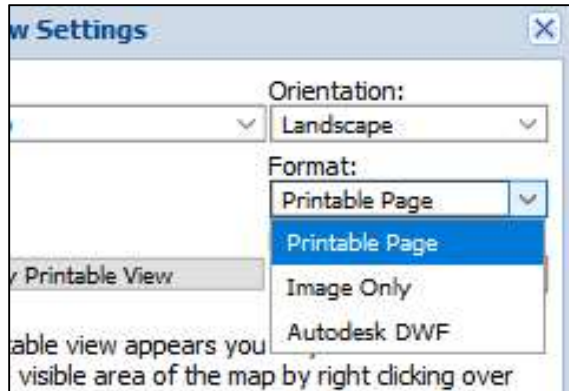

Both of these options will load in a new tab, to be printed from your browser. Image Only will print only the map. Printable page will print mostly the map, with a few basic details such as building name and scale.

Finally, select the area you would like to print under "Printable Area". You can print the entire floor you are viewing, or your zoom window only.

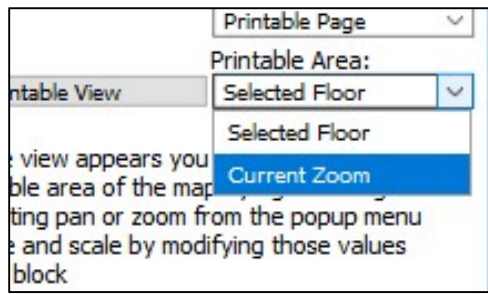

When finished selecting your print options, click "Display Printable View" to open your image in a new tab and print through your browser. Here is an example of formatting a printout as a Printable Page:

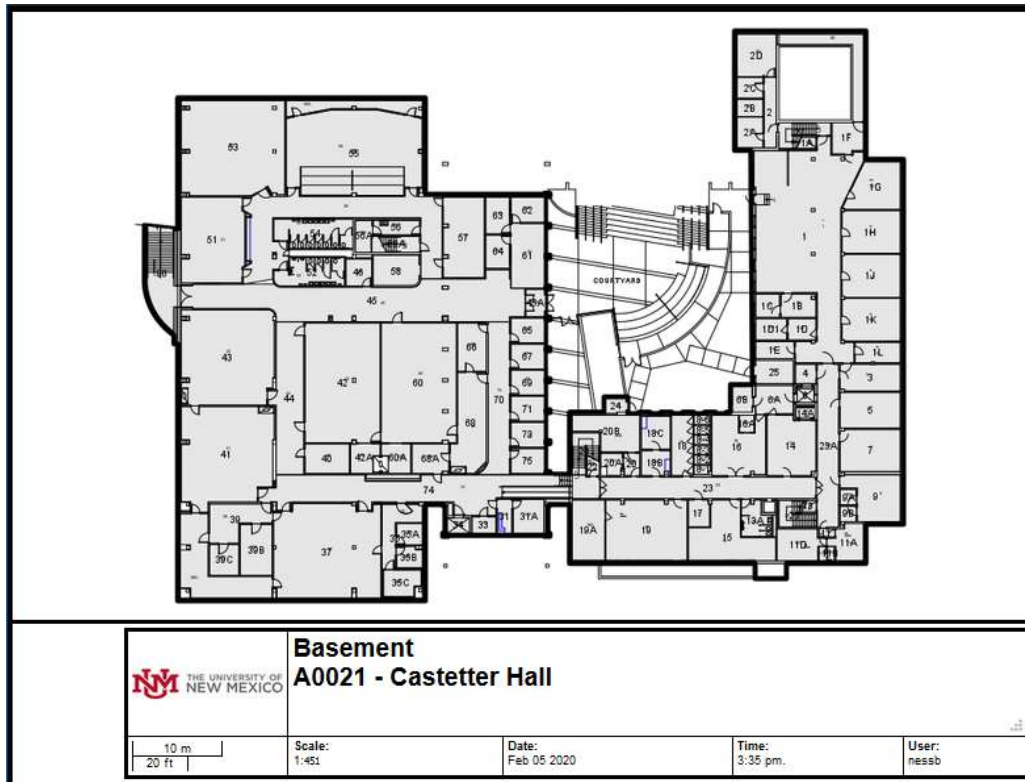

Using the Map Legend

Another way to impact how you view the visual map is through the Legend options, where you can toggle layers of the AutoCAD drawing. The button to open the Legend may be difficult to find at first:

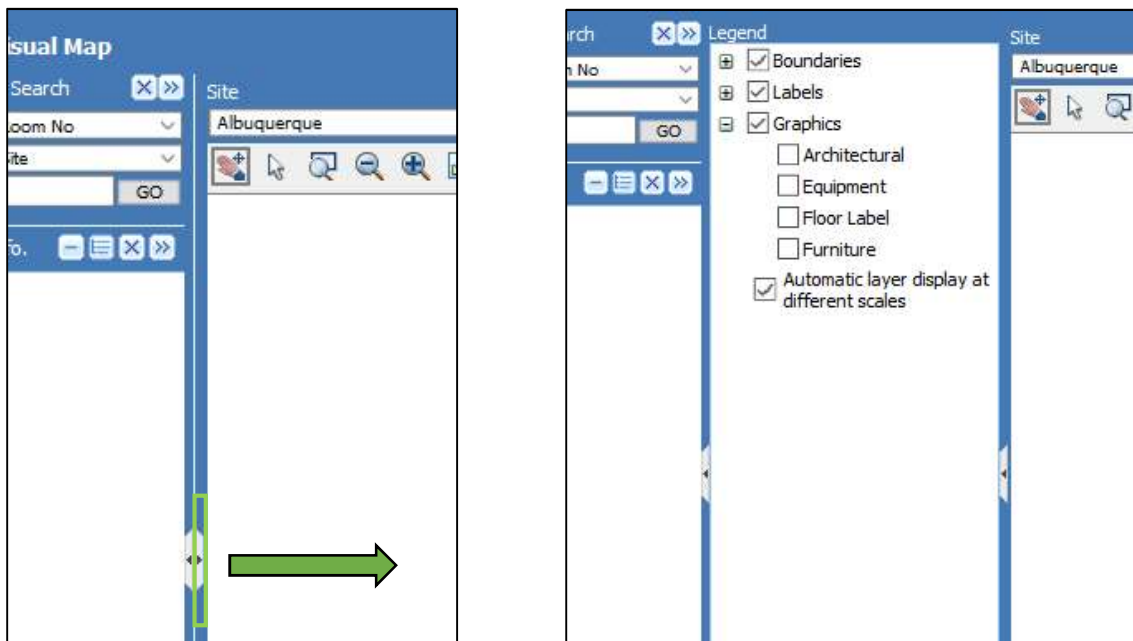

On the border between the Visual Map Search and the map image, there are two very small arrows. As shown above, click the one pointing toward the map. This will open up the Legend. Clicking it again will close it.

Open or close the sets of layer options by clicking the + or – to the left of them:

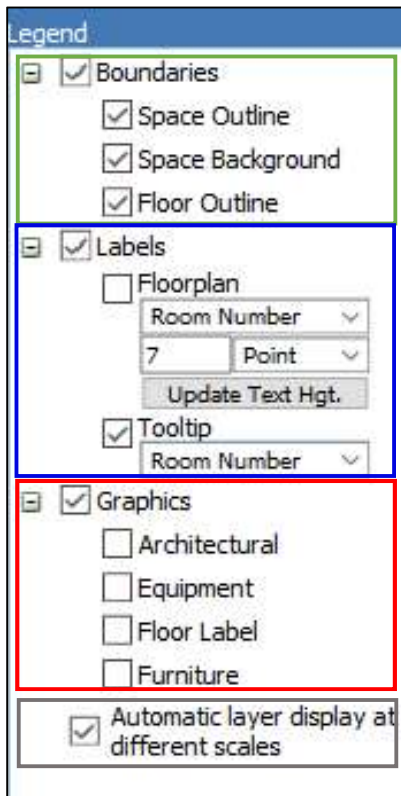

- **Boundaries:** to turn on or off the Space background color, floor outlines, or the outlines of the entire Space. These options may help to focus on room shapes and details in a printout.
- **Labels:** to turn on or off labels for room numbers, square footage, or assets, either directly on the floorplan or as tooltips (displayed when holding the mouse over a feature). This section also offers the option to adjust the label text size.
- **Graphics:** layers displaying extra architectural detail, equipment, floor detail, and furniture.
- **Automatic Layer Display:** If this box is checked, FAMIS will automatically display more detail layers the further you are zoomed into the image.

Applying Themes

The legend is also where Visual Map Themes will appear, if you choose to apply them.

Just like in FAMIS Classic, Themes visually illustrate how a Space attribute is distributed throughout a Property. The Themes menu can be found on the top bar, to the right of the Floor menu.



The two groups of themes you will see in this dropdown menu are themes related to Ownership and Occupation, and other Space Management data.

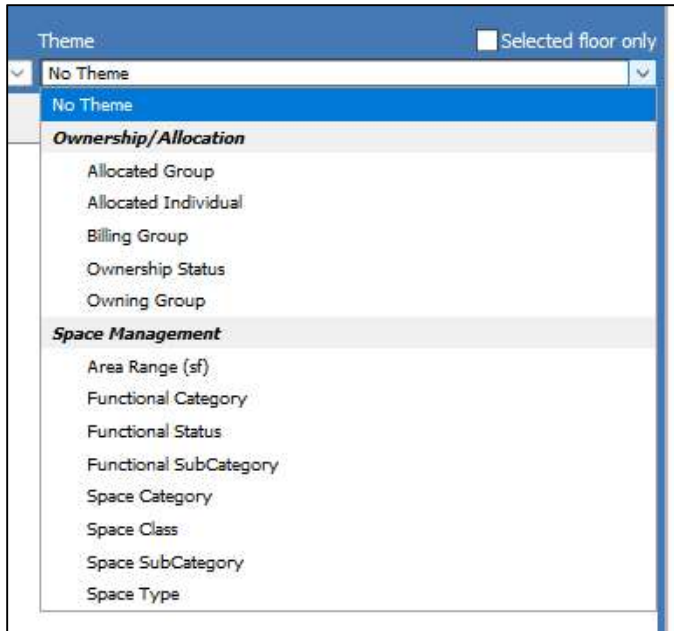

For an example, you may want to visually look at the Allocated Groups for the spaces across Castetter's Basement floor. Zoomed in to focus on the Castetter Basement, navigate to the Theme menu.

Then, select the Allocated Group theme, located under the Ownership and Allocation themes:

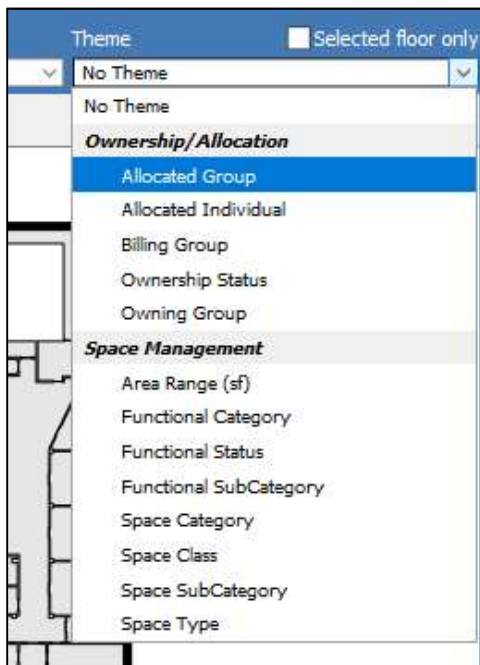

When you select the theme, a different color or hatching will appear on the Visual Map for each Space's Allocated Group.

To the Left, the map Legend will open with a new section identifying what each of the Theme's colors stands for.

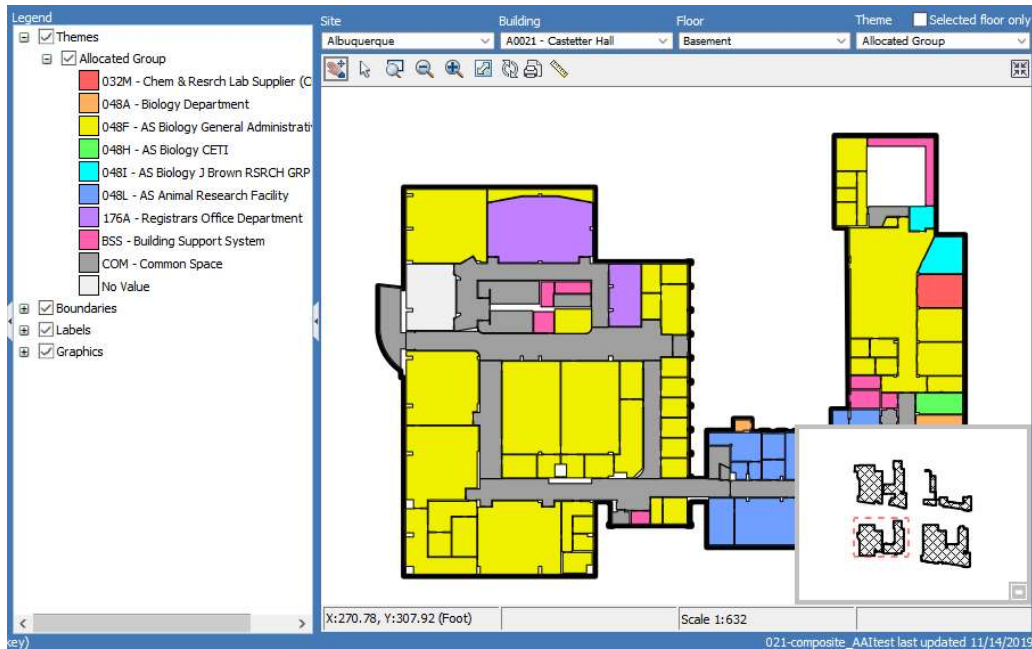

This color key in the Legend will display if you print the Visual Map.

Another way to focus a theme on only one floor, in addition to zooming the image, is to check the “Selected Floor Only” box above the Themes menu:

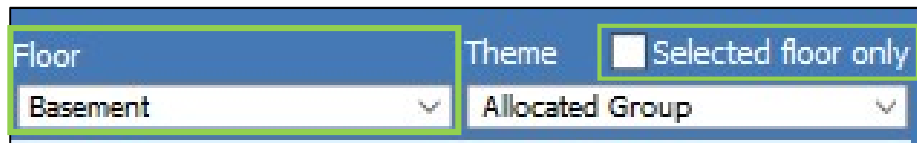

This will apply the theme colors to only the floor you have selected to the left.

Questions?

We hope this this helps you to find your way around the new FAMIS Cloud user interface.

Contact the Space team at space@unm.edu if any of the FAMIS tools in this guide are not working as they should, or you are in need of data that these FAMIS Cloud tools do not provide.

Appendix: FAMIS Cloud Search Terms Glossary

FAMIS Cloud	FAMIS Classic	Description
<i>Property Search</i>		
City	City	The city the Property is located in.
Country		The country the Property is located in.
External Property ID 1	Building	Building number
External Property ID 2		<i>[unused field]</i>
Property	Building + Name	A concatenation of the building number and name.

Property Type		<i>[currently unused field]</i>
Region	Site	The campus or site of the Property, such as Albuquerque, Valencia, Remotes, etc.
Sq. Footage Range	Building Gross SF	A field for estimating the square footage of the Property within a range. Search results will be in that range.
State/Province		The state the Property is located in.
Status	Status	Whether the building is in use - may be Active or Inactive.
Zip	Zip_Code	The zip code the property is within.
Space Search		
Active?	Status	Whether the Space is in use.
Allocated Group	Allocated Group	Searches Complex Allocations for departments associated with the Space.
Allocated Individual	Allocation Employee	Searches Complex Allocations for individuals associated with the Space.
Allocation Date		Searches Complex Allocations for the dates individuals, categories, and functions are assigned to a Space.
Area	Net Usable SqFt	A field for estimating the square footage of the Space within a range. Search results will be in that range.
Billing Group		<i>[unused Space field]</i>
Capacity		Room capacity in number of persons. UNM tracks occupancy through the Room Details.
Functional Category	Function + Description	A dropdown list of Space Functions as they have appeared in FAMIS Classic reports: 1.0 INSTRUCTION, 11.0 HOSPITAL, etc.
Functional Sub-Category	Function + Description	Functional subcategories as they appeared in FAMIS Classic reports: 1.2 DEPARTMENTAL RESEARCH, etc.
Include Complex Allocations?		Select if you would like FAMIS Cloud to include data in Complex Allocations in its search. "Yes" is encouraged.
Occupancy Status		New FAMIS Cloud field. Is the building occupied, partially occupied, or unoccupied?
Occupant	Occupant List	Searches FAMIS data for those listed on a Space as Occupants. These are separate from Complex Allocations.
Owning Group		<i>[unused field]</i>
Space Category	Space Category	Searches Complex Allocations for the Space Category of the Space, as seen in FAMIS Classic.
Space Description	Room	The Space's room number.
Space Sub-Category	Subcat	Searches Complex Allocations for the Space Subcategory of the Space, as seen in FAMIS Classic.
Space Type		Searches Complex Allocations for the Space Type of the Space, a new subtype of Space Subcategory.
Total Occupants		Number of listed occupants in the Space. Rarely used in UNM reporting.

Vacancy		Number of vacancies - slots where an occupant could be assigned to the Space, but isn't. Rarely used in UNM reporting.
---------	--	--